



ANALEMMA

THE ARCHITECT OF LIFE

Have a question regarding the whole house Analemma unit?

Send us an e-mail at [info@analemma-water.com](mailto:info@analemma-water.com), and we will happily assist you!

Want to learn more about Analemma?  
Visit us at [analemma-water.com](http://analemma-water.com)

Analemma Water is created in the Netherlands.  
Analemma Water distribution: New Earth Technologies Ltd.

Follow us on:

 Analemma Water  [analemmawater\\_](https://www.instagram.com/analemmawater_)  [@analemmawater1346](https://www.youtube.com/@analemmawater1346)



ANALEMMA

THE ARCHITECT OF LIFE

WHOLE HOUSE ANALEMMA  
INSTALLATION INSTRUCTIONS

## INSTALLATION INSTRUCTIONS

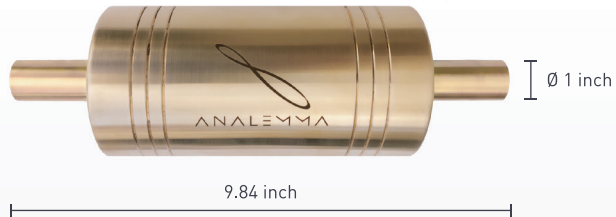

### WARNING:

**SOLDER AND WELDING ARE PROHIBITED.**

**While installing compression fitting only put pressure on the fitting itself, not on the pipes of unit.**

A certified plumber is required for the installation of the whole house unit. The whole house Añalemma unit is fitted with a standard 1 inch piping. If the pipe size in your home differs from the size of Añalemma whole house unit, make sure your plumber acquires a reducer/adapter.

For example, if you have a 3/4 inch piping, a reducer that will connect the 3/4 inch piping to our standard 1 inch piping on the whole house Añalemma unit is required to properly install the whole house unit.

There are TWO ways to connect the Añalemma unit depending on what kind of plumbing system you use. Standard methods used are press fitting or compression fitting.

**NOTE:** The Whole house Añalemma unit is made of brass, which is susceptible to discoloration. This does not affect the function of the unit. If you notice discoloration on your Whole house Añalemma and you find the discoloration aesthetically displeasing, we recommend polishing the unit with brass polish to remove the tarnish and help maintain its natural color. The unit might also contain minor scratches, which are a result of the manufacturing process of raw materials used in the unit. The scratches do not affect the function of the unit.

**1** Turn your water system off. Make sure the pressure is off by releasing it via a tap in the house.

**2** The Añalemma unit comes with a mounting bracket with two prefabricated mounting holes. Define the best location to fit the Añalemma, preferably close by where the water piping enters the house.

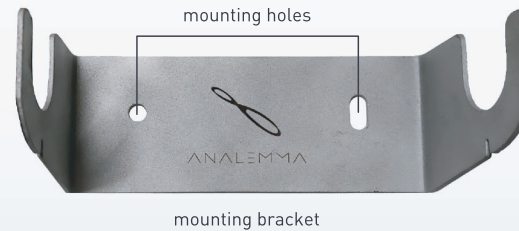

**3** When you have defined the best location for the Añalemma unit, calculate the total length of piping you need to take out to fit the unit between the piping. Total length of the unit is 9.84 inch and add, depending on the plumbing system you use, the space needed to fit the connecting plumbing pieces.

**4** There are two ways to place the Añalemma unit, horizontal and vertical. Place the mounting bracket level against the wall and mark the two prefabricated holes on the wall. Leave the unit out of the bracket while marking the drill holes. When unit is in, you can't reach the drill holes to mark them.

**5** Drill the holes on the markings and place two wall plugs 0.31 inch.



**6** Place the mounting bracket level on the wall and screw the two screws with steel ring in place. Connect the Añalemma unit with your designated plumbing system and turn on the water pressure - make sure that there is no leakage on your connections.

**Your Añalemma unit is ready for use.**

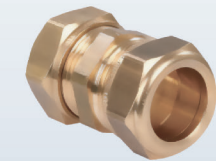

Compression fitting  
1 inch



Press fitting  
1 inch

